



# EVERLIGHT ELECTRONICS CO.,LTD.

Device Number : DLE-125-020 REV: 2.0

3mm Round Small Flange Without stand-off LEDs, T-1

PART NO : 1254GD ECN : \_\_\_\_\_ Page: 1/4

### Features :

- High luminous power.
- Can be driven at low current.
- 2.54mm lead spacing.
- Available on tape and reel.

### Description :

- The series is specially designed for applications requiring higher brightness.
- The LED lamps are available with different colors,intensities, epoxy colors, etc.

### Package Dimensions:

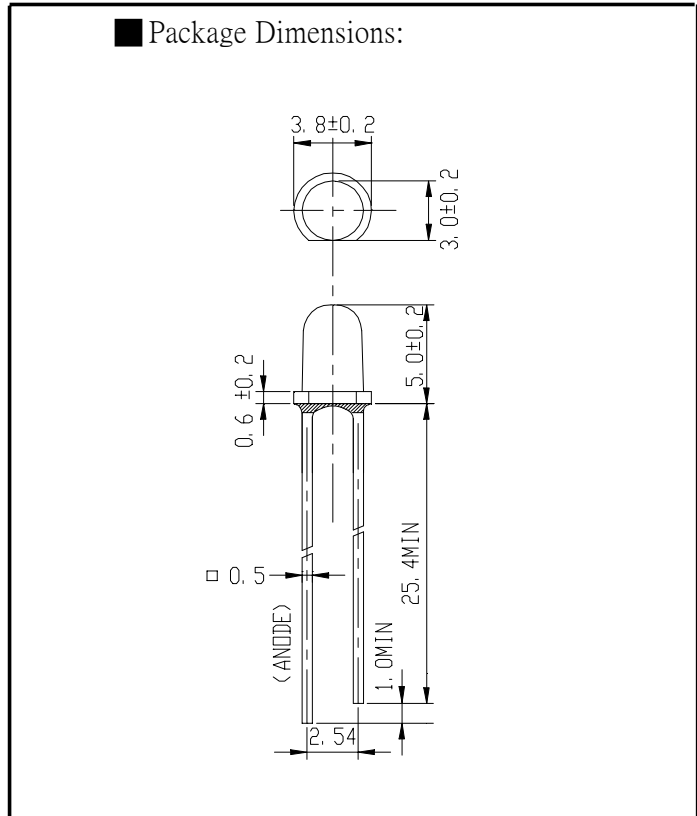

### Applications :

- TV Set
- Monitor
- Telephone
- Computer

### Notes :

- 1.All dimensions are in millimeters.
- 2.An epoxy meniscus may extend about 1.5mm(0.059") down to the lead.

PART NO	Chip		Lens Color
	Material	Emitted Color	
1254GD	GaP	Green	Grren Diffused

OFFICE : NO. 25,Lane 76,Sec.3, Chung Yang Rd., Tucheng 236, Taipei, Taiwan, R.O.C.

TEL : 886-2-2267-2000,2267-9936

FAX : 886-2-2267-6244,22676189,22676306

<http://www.everlight.com>



# EVERLIGHT ELECTRONICS CO.,LTD.

Device Number : DLE-125-020 REV: 2.0

3mm Round Small Flange Without stand-off LEDs, T-1

PART NO : 1254GD ECN :                      Page: 2/4

## ■ Absolute Maximum Ratings at Ta = 25°C

Parameter	Symbol	Rating	Unit
Forward Current	IF	30	mA
Operating Temperature	Topr	-40 to +85	°C
Storage Temperature	Tstg	-40 to +100	°C
Soldering Temperature	Tsol	260 ± 5	°C
Power Dissipation	Pd	100	mW
Peak Forward Current(Duty 1/10 @ 1KHz)	IF(Peak)	160	mA
Reverse Voltage	VR	5	V

## ■ Electronic Optical Characteristics :

Parameter	Symbol	Min.	Typ.	Max.	Unit	Condition
Luminous Intensity	Iv	10.0	16.0	----	mcd	IF=10mA
Viewing Angle	2θ 1/2	----	40	----	deg	IF=20mA
Peak Wavelength	λ p	----	565	----	nm	IF=20mA
Dominant Wavelength	λ d	----	570	----	nm	IF=20mA
Spectrum Radiation Bandwidth	△ λ	----	30	----	nm	IF=20mA
Forward Voltage	VF	1.7	2.1	2.4	V	IF=20mA
Reverse Current	IR	----	----	10	μ A	VR=5V



# EVERLIGHT ELECTRONICS CO.,LTD.

Device Number : DLE-125-020

REV: 2.0

3mm Round Small Flange Without stand-off LEDs, T-1

PART NO : 1254GD

ECN :                     

Page: 3/4

## ■ Typical Electro-Optical Characteristic Curves

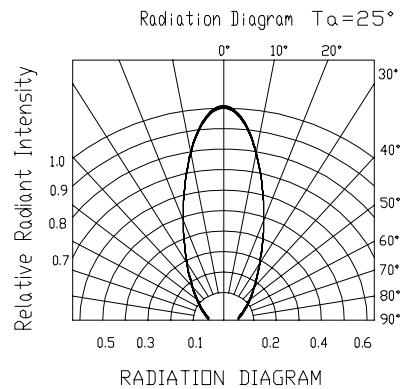
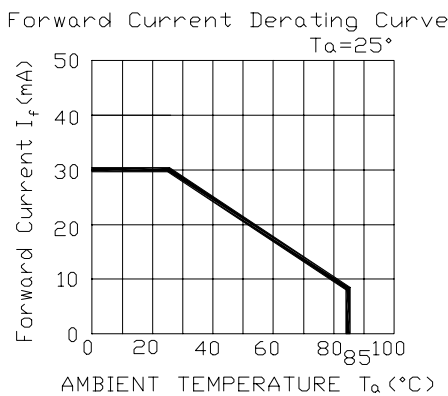
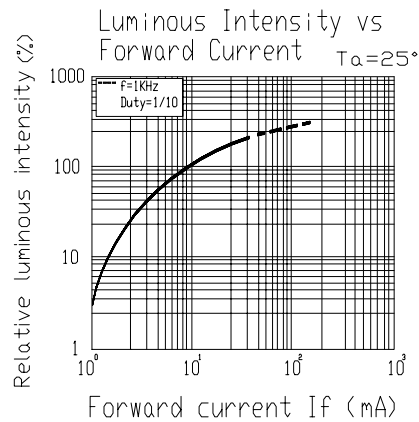
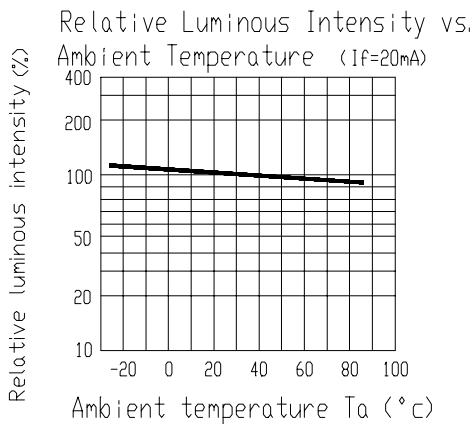
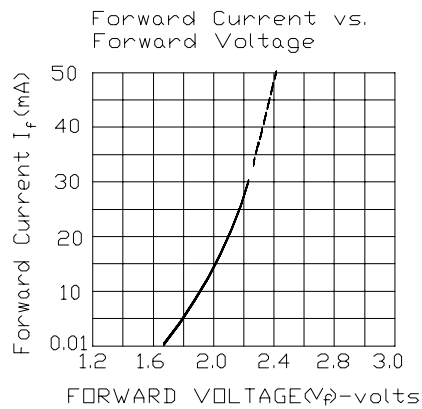
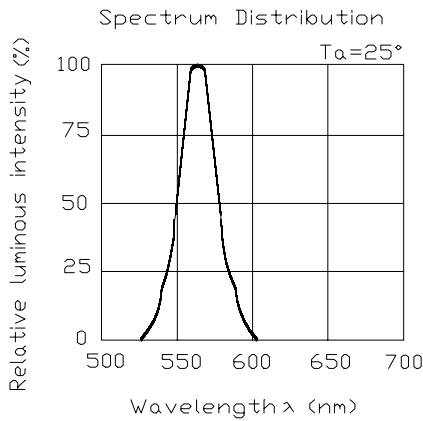



# EVERLIGHT ELECTRONICS CO.,LTD.

Device Number : DLE-125-020 REV: 2.0

3mm Round Small Flange Without stand-off LEDs, T-1

PART NO : 1254GD ECN :  Page: 4/4

## ■ Reliability test items and conditions

NO	Item	Test Conditions	Test Hours/Cycle	Sample Size	Ac/Re
1	Solder Heat	TEMP : 260°C ± 5 °C	5 SEC	76 PCS	0/1
2	Temperature Cycle	H : +85°C 30min ∫ 5 min L : -55°C 30min	50 CYCLES	76 PCS	0/1
3	Thermal Shock	H : +100°C 5min ∫ 10 sec L : -10°C 5min	50 CYCLES	76 PCS	0/1
4	High Temperature Storage	TEMP : 100°C	1000 HRS	76 PCS	0/1
5	Low Temperature Storage	TEMP : -55°C	1000 HRS	76 PCS	0/1
6	DC Operating Life	IF = 20 mA	1000 HRS	76 PCS	0/1
7	High Temperature / High Humidity	85°C/85% RH	1000 HRS	76 PCS	0/1