

12 Series Tact Switches

NEW (SMD Type optional)

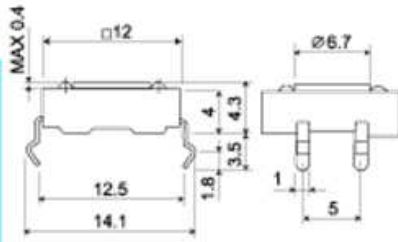

1243



Rating : 50mA 12V DC.
 Travel : 0.3±0.15mm.
 Contact resistance : 100mΩ Max.
 Operating force : 130, 160, 250±50g.
 Life : 100,000 Cycles Min.

SMD TYPE

1243 SMD

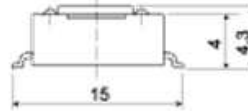

1273 SMD

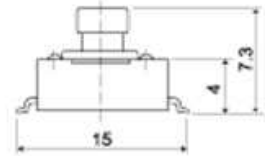

1275

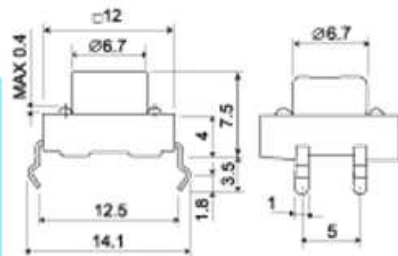

Rating : 50mA 12V DC.
 Travel : 0.3±0.15mm.
 Contact resistance : 100mΩ Max.
 Operating force : 130, 160, 250±50g.
 Life : 100,000 Cycles Min.



1243V

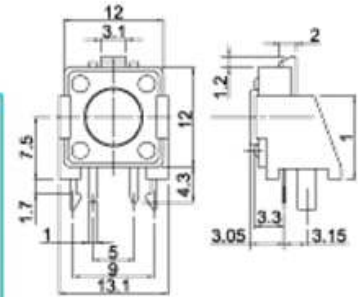

Rating : 50mA 12V DC.
 Travel : 0.3±0.15mm.
 Contact resistance : 100mΩ Max.
 Operating force : 130, 160, 250±50g.
 Life : 100,000 Cycles Min.



1212

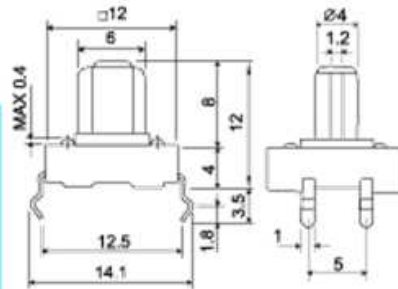

Rating : 50mA 12V DC.
 Travel : 0.3±0.15mm.
 Contact resistance : 100mΩ Max.
 Operating force : 130, 160, 250±50g.
 Life : 100,000 Cycles Min.



1212D

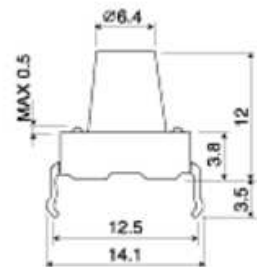

Rating : 50mA 12V DC.
 Travel : 0.3±0.15mm.
 Contact resistance : 100mΩ Max.
 Operating force : 130, 160, 250±50g.
 Life : 100,000 Cycles Min.



1273

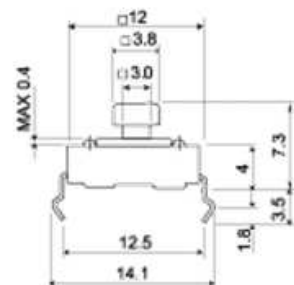

1273C CAP  1273R CAP 

KM8  KM4  KM6 